

CT81 HIGH VOLTAGE CERAMIC CAPACITOR

FEATURES

Use for coupling, and by-pass circuit.
Stable and high reliability products

SPECIFICATIONS

OPERATING TEMPERATURE RANGE	Class 1 -25°C to +125°C Class 2 -25°C to +105°C
TEMPERATURE COEFFICIENTS	Class 1 NPO SL Class 2 Y5P Y5U Y5V
RATED WORKING VOLTAGE	500V - 6000V. DC
CAPACITANCE RANGE	100pF – 10,000pF
TEST VOLTAGE	2 times of the rated voltage.
INSULATION RESISTANCE	10,000 MΩ or 200 MΩ whichever is the smaller
DISSIPATION FACTOR (tanδ)	at 1 KHz, ±0.2 Vrms, 25°C Y5P, Z5U: tan δ ≤ 2.5% Y5V Y5U: tan δ ≤ 5% NPO SL <30P Q>600 >=30P Q>1000

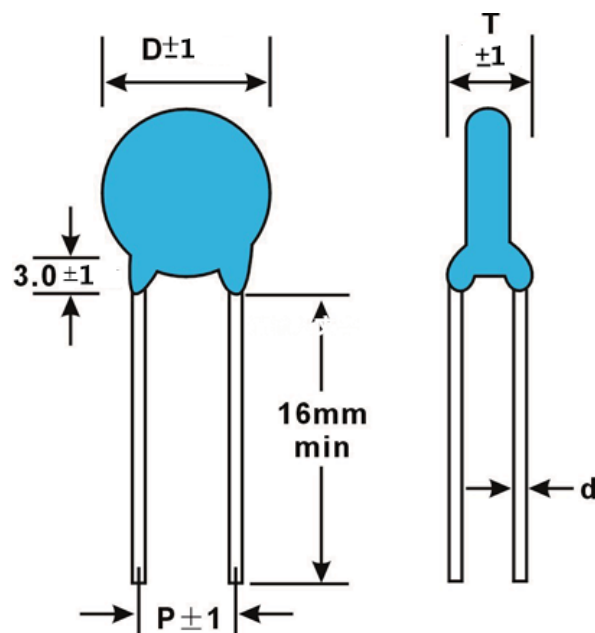

How to order

CT81	P	102	K	1000	0050	B	000
Type	Material Code	Capacitance Code	Tolerance	Rated Voltage	Size Code	Package Code	Suffix Indicate Special Requirement
CT81	<u>Code for Dielectrics</u> B: X7R E: Z5U Z: Y5V U: Y5U P: Y5P V: Z5V X: X5R Y: Y5T D: N4700 N: NPO S: SL	<u>pF Code: 1st two digits</u> represent significant figures 3rd digit represents multiplier (number of zeros to follow) 104 = 0.1µF 100 = 10pF 470 = 47pF 0R1 = 0.1pF R47 = 0.47pF	K: +/-10% J: +/-5% K: +/-10% M: +/-20% Z: +80-20%	<u>For DC Voltage</u> 0500: 500VDC 2000: 2000VDC 3000: 3000VDC	<u>Pitch for CT81</u> 0050: pitch size 5mm 0075: pitch size 7.5mm 0100: pitch size 10mm 5mm pitch Shape 4=4050 First number indicates lead shape, rest three numbers indicates pitch size 050=5mm 075=7.5mm 100=10mm	<u>B: Bulk</u> <u>A: Ammo Taped</u> <u>R: Tape & Reel</u>	<u>000: Indicating Standard</u> <u>If for cut leads or long leads:</u> 000: mean standard LL 035: cut leads to 3.5mm 040: cut leads to 4mm 250: 25mm long leads

Lead Styles:

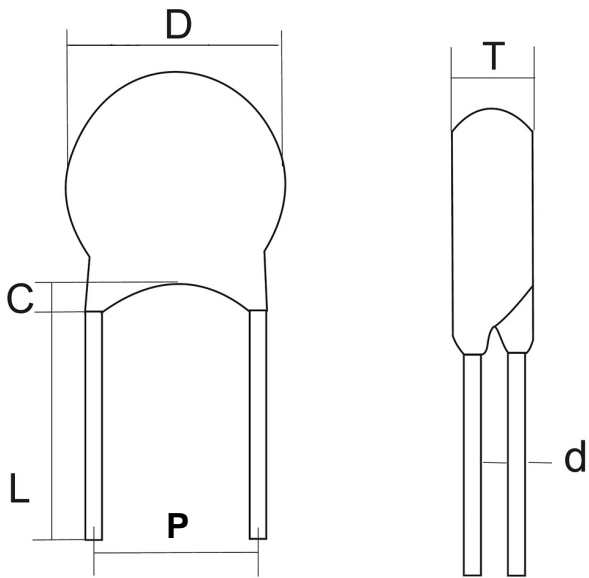

Code 0: Long straight lead

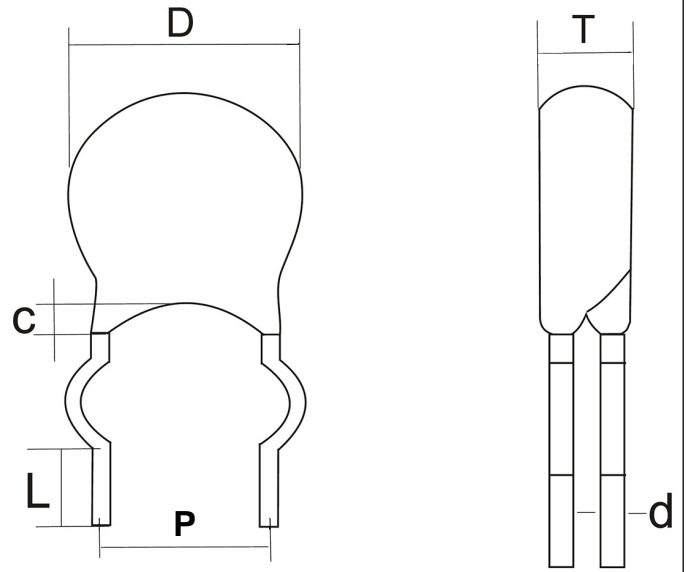

Code 2: Outside kink lead

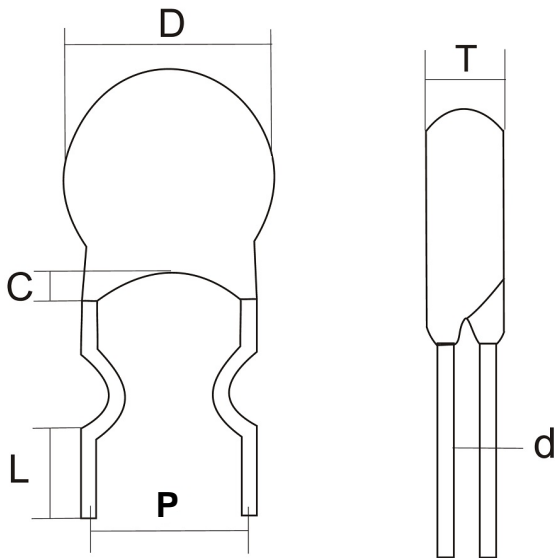

Code 4: inside kink lead

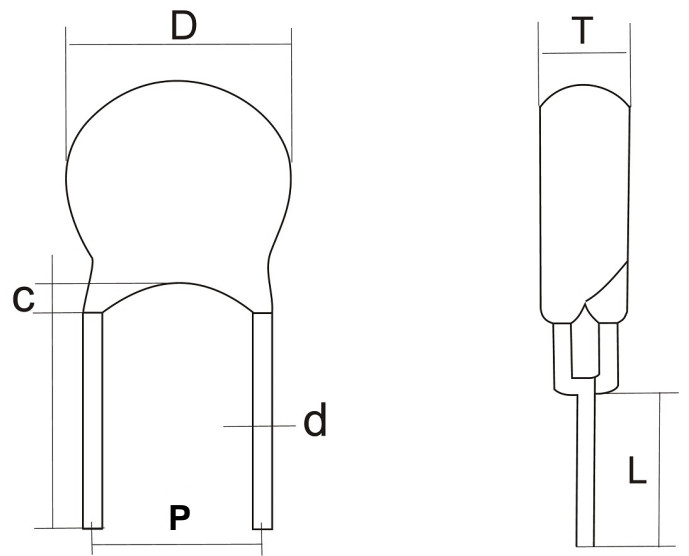

Code 8: Y kink lead

CT81 HIGH VOLTAGE CERAMIC CAPACITOR

Item		500V				1 KV				2 KV				3 KV				Remark
Dielectric	Capacitance Code Tolerance Code	D±1	T±1	P±1	d±0.05	D±1	T±1	P±1	d±0.05	D±1	T±1	P±1	d±0.05	D±1	T±1	P±1	d±0.05	
NPO	1R0-9R0 D	5.5	2.2	5.0	0.5	5.5	2.2	5.0	0.5	6.0	2.3	5.0	0.5	6.0	3.5	7.5	0.7	
NPO	100 K	5.5	2.2	5.0	0.5	5.5	2.2	5.0	0.5	6.0	2.3	5.0	0.5	6.0	3.5	7.5	0.7	
SL	120-101K	5.5	2.2	5.0	0.5	5.5	2.2	5.0	0.5	6.0	2.8	5.0	0.5	6.0	3.5	7.5	0.7	
Y5P	120-101K	5.5	2.2	5.0	0.5	6.0	2.3	5.0	0.5	6.0	2.8	5.0	0.5	6.1	3.5	7.5	0.7	
Y5P	151-561K	6.0	2.2	5.0	0.5	6.0	2.3	5.0	0.5	6.0	3.0	5.0	0.5	6.0	3.5	7.5	0.7	
Y5U	102M	6.5	2.3	5.0	0.5	/	/	/	/	5.6	3.0	5.0	0.5	6.0	3.5	7.5	0.7	
Y5P	681-102K	6.0	2.2	5.0	0.5	6.5	2.3	5.0	0.5	8.0	3.0	5.0	0.5	9.1	3.5	7.5	0.7	
Y5V	122-222M	6.0	2.2	5.0	0.5	/	/	/	/	6.0	3.0	5.0	0.5	6.0	3.5	7.5	0.7	
Y5U	122-222M	6.0	2.2	5.0	0.5	7.0	2.3	5.0	0.5	8.0	3.0	5.0	0.5	9.1	3.5	7.5	0.7	
Y5P	122-222K	8.0	2.2	5.0	0.5	8.5	2.3	5.0	0.5	11.0	3.0	7.5	0.6	13.0	3.5	7.5	0.7	
Y5V	272-472M	6.0	2.2	5.0	0.5	6.5	2.5	5.0	0.5	8.0	3.0	7.5	0.6	9.0	3.5	7.5	0.6	
Y5U	272-472M	7.0	2.2	5.0	0.5	8.0	2.3	5.0	0.5	10.0	3.0	5.0	0.5	13.1	3.8	10.0	0.7	
Y5P	272-472K	11.0	2.2	5.0	0.5	12.0	2.3	5.0	0.5	14.4	3.0	7.5	0.6	/	/	/	/	
Y5P	562K	12.0	2.5	5.0	0.5	13.0	2.5	7.5	0.6	17.0	3.0	7.5	0.6	/	/	/	/	
Y5V	682-103M	8.0	2.2	5.0	0.5	9.0	2.3	5.0	0.5	10.0	3.0	7.5	0.6	11.0	3.5	7.5	0.7	
Y5U	682-103M	9.0	2.2	5.0	0.5	12.0	2.3	5.0	0.5	14.4	3.0	10.0	0.6	17.2	3.8	10.0	0.7	
Y5V	153-223M	11.0	2.2	5.0	0.5	13.5	2.5	7.5	0.6	15.0	3.5	10.0	0.6	/	/	/	/	
Y5V	473M	17.0	2.5	7.5	0.6	17.0	2.5	10.0	0.7	21.0	3.5	10.0	0.7	/	/	/	/	
Y5V	473M	15.0	2.3	7.5	0.5	17.5	2.5	10.0	0.7	21.0	3.5	10.0	0.7	/	/	/	/	
Y5V	104M Φ19	20.0	2.3	7.5	0.5	20.4	2.8	10.0	0.7	26.5	3.5	10.0	0.7	/	/	/	/	
Y5V	104M Φ24	23.5	2.3	7.5	0.5	22.4	2.8	10.0	0.7	26.5	3.5	10.0	0.7	/	/	/	/	

Item		4KV				5KV				6KV				Remark
Dielectric	Capacitance Code Tolerance Code	D±1	T±1	P±1	d±0.05	D±1	T±1	P±1	d±0.05	D±1	T±1	P±1	d±0.05	
Y5P	101 K	6.0	3.0	7.5	0.6	6.0	3.5	10.0	0.6	6.0	3.5	10.0	0.6	
Y5P	151 K	6.0	3.5	7.5	0.6	6.0	4.5	10.0	0.6	6.0	4.5	10.0	0.6	
Y5P	221 K	6.0	3.5	7.5	0.6	6.0	4.5	10.0	0.6	6.0	4.5	10.0	0.6	
Y5P	271 K	7.0	3.5	7.5	0.6	6.0	4.5	10.0	0.6	6.0	4.5	10.0	0.6	
Y5P	331 K	6.5	3.5	7.5	0.6	7.0	4.5	10.0	0.6	7.0	4.5	10.0	0.6	
Y5U	331 K	/	/	/	/	6.0	4.5	10.0	0.6	6.0	4.5	10.0	0.6	
Y5P	471 K	6.5	3.5	7.5	0.6	8.0	4.5	10.0	0.7	8.0	4.5	10.0	0.7	
Y5U	471 K	/	/	/	/	6.0	4.5	10.0	0.6	6.0	4.5	10.0	0.6	
Y5P	561 K	7.0	3.5	7.5	0.6	9.0	4.5	10.0	0.7	9.0	4.5	10.0	0.7	
Y5U	561 K	/	/	/	/	7.0	4.5	10.0	0.6	7.0	4.5	10.0	0.6	
Y5P	681 K	7.5	3.5	7.5	0.6	9.0	4.5	10.0	0.7	9.0	4.5	10.0	0.7	
Y5P	102 K	9.0	3.5	7.5	0.6	11.0	4.5	10.0	0.7	11.0	4.5	10.0	0.7	
Y5U	102 M	6.0	3.5	7.5	0.6	7.0	4.5	10.0	0.6	7.0	4.5	10.0	0.6	
Y5V	102 M	/	/	/	/	6.0	4.5	10.0	0.6	6.0	4.5	10.0	0.6	
Y5U	152 M	8.0	3.5	7.5	0.6	9.0	4.5	10.0	0.6	9.0	4.5	10.0	0.6	
Y5V	152 M	6.0	3.5	7.5	0.6	7.0	4.5	10.0	0.6	7.0	4.5	10.0	0.6	
Y5U	222 M	9.0	3.5	7.5	0.6	10.0	4.5	10.0	0.7	10.0	4.5	10.0	0.7	
Y5V	222 M	7.0	3.5	7.5	0.6	8.0	4.5	10.0	0.7	8.0	4.5	10.0	0.7	
Y5U	332 M	11.0	3.5	7.5	0.6	13.5	4.5	10.0	0.7	13.5	4.5	10.0	0.7	
Y5V	332 M	8.0	3.5	7.5	0.6	10.0	4.5	10.0	0.7	10.0	4.5	10.0	0.7	
Y5U	472 M	13.0	3.5	10.0	0.7	16.5	5.0	10.0	0.7	16.5	5.0	10.0	0.7	
Y5V	472 M	9.0	3.5	7.5	0.6	11.0	4.5	10.0	0.7	11.0	4.5	10.0	0.7	
Y5U	103 M	17.5	3.5	10.0	0.7	/	/	/	/	18.5	4.5	10.0	0.7	
Y5V	103 M	13.5	3.5	10.0	0.7	/	/	/	/	/	/	/	/	
Y5V	203 M	20.5	3.5	10.0	0.7	/	/	/	/	/	/	/	/	
Y5V	223 M	20.5	3.5	10.0	0.7	/	/	/	/	/	/	/	/	

Ammo Taped and Cut Leads are available on request. Special size is on request too.
Please consult to sales if you need higher voltage than 6KV or other values.